

MINI MAX PARTS LIST

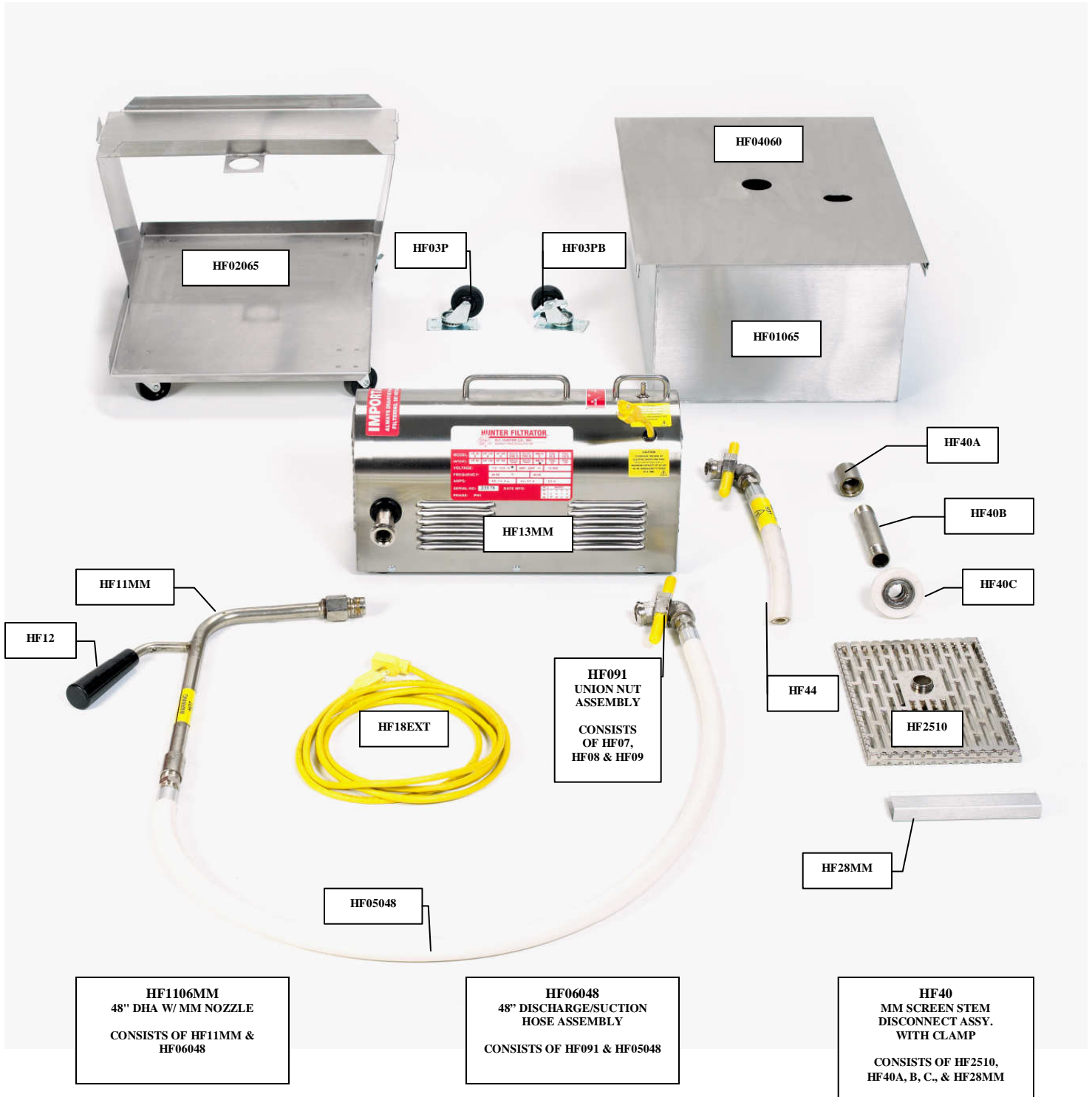

See enlarged view of FILTRATOR™ Power Unit (HF13MM) on reverse side.

MINI MAX PARTS LIST

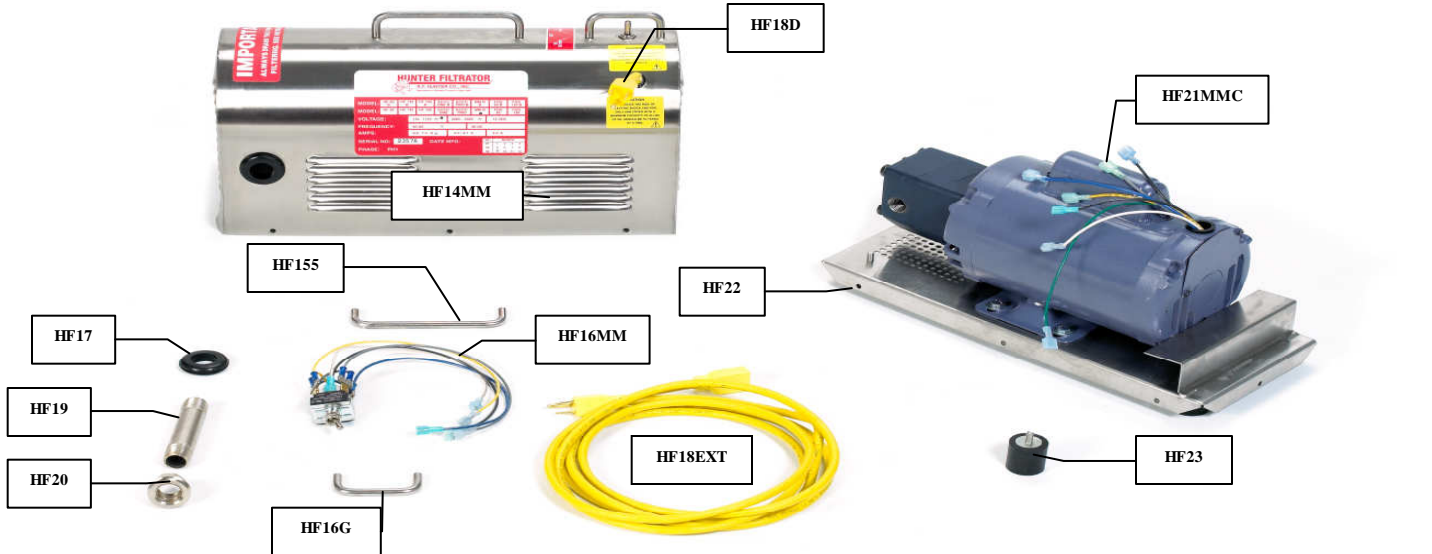

HF01065 CONTAINER WITH COVER
Stainless steel, rectangular shape. 14" x 22" x 9".

HF02065 CART
Stainless steel frame with four 2" diameter casters mounted underneath.

HF03P CASTER
2" diameter wheel located under cart.

HF03PB CASTER WITH LOCK
2" diameter wheel with lock located under cart.

HF04060 CONTAINER COVER
Stainless steel rectangular shape to fit over container.

HF05048 DISCHARGE/SUCTION HOSE
½" diameter., 48" length, wire reinforced hose with 2 hose nipples and 2 hose ferrules.

HF06048 DISCHARGE/SUCTION HOSE ASSEY.
Same as HF05048 with Union Nut Assembly (HF091)

HF07 STREET ELBOW
½" 90° street elbow attaches to hose nipple.

HF08 BALL END
Screws onto ½" street elbow through union nut and attaches union nut to the pump nipple. Part of Union Nut Assembly (HF091).

HF09 UNION NUT
Octagonal shaped with 2 molded yellow handles, inside thread. Attaches screen stem assembly and discharge hose assembly to pump nipple sockets of power unit.

HF091 UNION NUT ASSEMBLY
Consists of HF07, HF08 & HF09. Attaches discharge hose and stem assemblies to pump nipple sockets.

HF10 UNION NUT HANDLES (Pre Feb. 2001 models)
Black phenolic with hole to fit union nut.

HF11MM DISCHARGE NOZZLE
Nickel plated pipe with black handle and discharge nozzle coupling.

HF1106MM 48" DHA W/ MM NOZZLE
Consists of HF11MM & HF06048.

HF12 DISCHARGE NOZZLE HANDLE
Black, phenolic, to fit discharge nozzle.

HF13MM POWER UNIT
Stainless Steel Construction "Mailbox" shape includes motor/pump combination, housing, base, housing handle, switch, switch guard, lead wire, pump nipples/sockets & grommets.

HF14MM POWER UNIT HOUSING
Stainless steel "Mailbox" cover. Includes housing handle, grommets, switch, switch guard & lead wire.

HF155 POWER UNIT HOUSING HANDLE
Located on top of Power Unit Housing (5" center to center).

HF16MM POWER UNIT SWITCH
Reversible two way toggle switch.

HF16G POWER UNIT SWITCH GUARD

HF17 GROMMET
Black rubber piece located on each side of power unit housing.

HF18D LEAD WIRE (6 inches in length)
3 wire electrical cord.

HF18EXT EXTENSION CORD
Lead wire extension cord.

HF19 PUMP NIPPLE
½" x 4" nickel plated piping, screws into pump through power unit housing.

HF20 PUMP NIPPLE SOCKET
Attaches to pump nipple. Union nut screws onto socket to attach discharge/suction hose or immersion hose assembly to power unit.

HF20C PUMP NIPPLE ASSEMBLY
Consists of HF19 & HF20.

HF21MMC MOTOR/PUMP
Closed, coupling pump/motor with capacitor. ½ H.P. Bidirectional

HF22 POWER UNIT BASE
Stainless steel, rectangular shaped with base feet and plastic cover for reset button access.

HF23 POWER UNIT BASE FOOT
Located on bottom of power unit base.

HF2510 7 x 10 MM SCREEN
2 piece nickel plated filter screen. (Used with Filter Envelope FE03).

HF28MM MM CLAMP
Stainless steel construction, used to hold paper envelope (FE03) on screen.

HF40 MM SCREEN STEM DISCONNECT ASSY.
Includes rectangular 2 piece screen (HF2510), screen stem coupling (HF40A), ¾" x 5" screen stem (HF40B), disconnect handle (HF40C) & clamp (HF28MM)

HF40A MM SCREEN STEM COUPLING ¾"
Nickel plated ¾" diameter straight coupling used to attach screen to screen stem.

HF40B MM SCREEN STEM ¾" X 5"
Nickel plated ¾" x 5" piping. Threads into stem coupling and disconnect handle.

HF40C MM DISCONNECT/HANDLE
Nickel plated with handle used to attach screen stem disconnect assembly to discharge nozzle coupling.

HF42 MM DISCH NOZZLE COUPLING (PHN)
Nickel plated, threaded onto the end of the nozzle. Used to attach screen stem disconnect assembly to nozzle.

HF43 MM IMMERSION HOSE ASSEMBLY
½" diameter wire reinforced hose 12" long with one end bevel cut. (HF44) and a union nut assembly (HF091).

HF44 MM IMMERSION HOSE
½" diameter white reinforced hose. 12" long with one hose ferrule and one hose nipple.